

Pneumatic Drill

1/2 inch

VIBRO

Efficient & Effective

PNEUMATIC DRILL (1/2 INCH)

Features:

- Forward and reverse switch, operation is flexible and easy
- Suitable for drilling holes in wood and metal plates
- Adding a gas regulating valve can achieve stepless speed regulation
- Hand self-locking chuck.

Machine use:

- Drilling, stir tapping, rust removal, hit the screw, sanding and polishing.



Pneumatic Oil



Air Inlet Connector

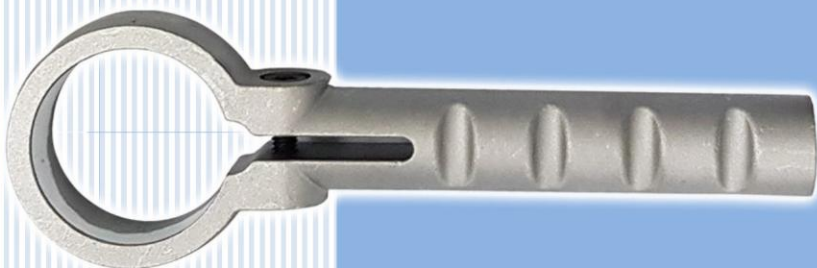
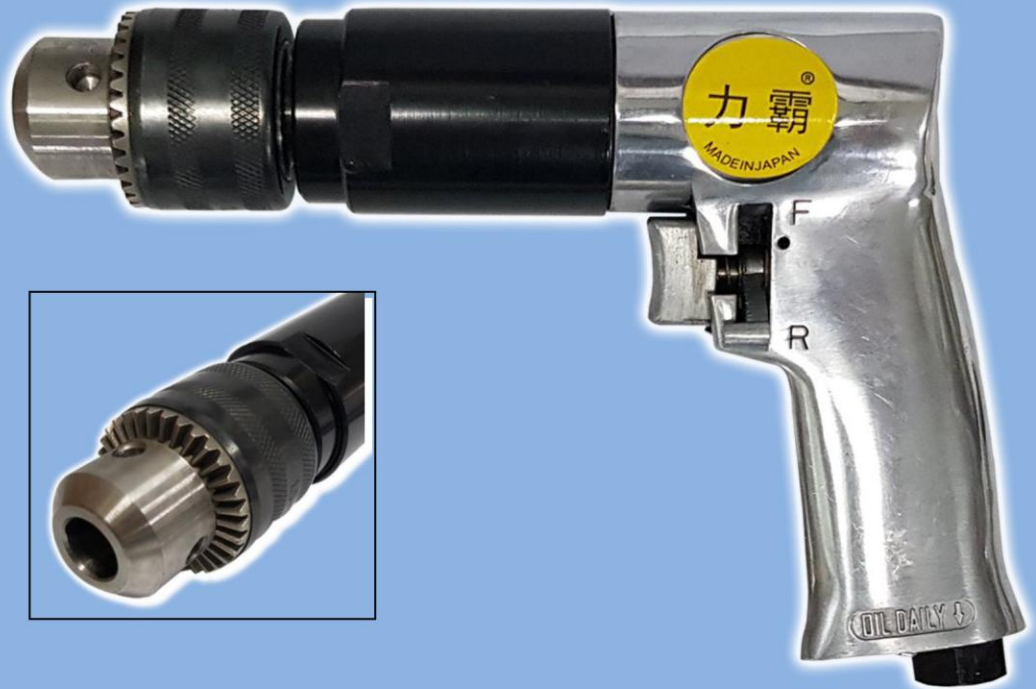

Model

Speed	700R.M.P
Chuck Size	13mm
Air Pressure	90P.S.I
Air consumption	17CFM
Air inlet	1/4npt
Hose size(id)	3/8
Overall Length	195mm
Weight	1.5kg

QUALITY

Designs and specifications are subject to change for improvement without prior notice.

2025 (JAN) - Rev. 0